

# DIGITAL INFLATOR KIT - TURBOFLOW SLEEVE VENTURI

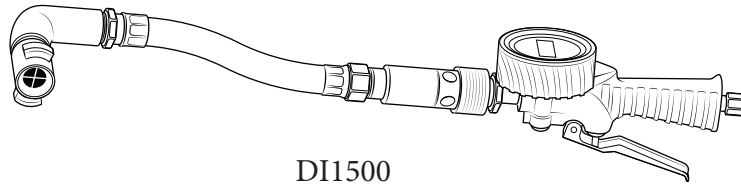

DI1500

## PART LIST



DI Base  
(DI1000)

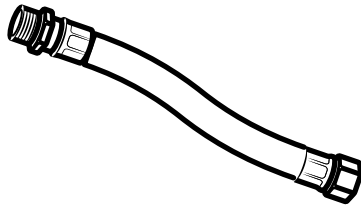

Inflation Hose TX/ TF  
(DI1020)

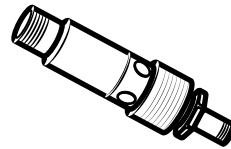

Sleeve Venturi  
(DI1060)



Turbo HD Gauged  
Inflator Tip  
(TF9020)

## ASSEMBLY INSTRUCTIONS

1. Twist the Sleeve Venturi onto the DI Base using the pretaped screw threads.
2. Twist the Inflation Hose onto the Sleeve Venturi using screw threads.
3. Twist the Turbo HD Gauged Inflator Tip onto the Inflation hose.

\*Tighten all joints with a wrench. Do not over tighten.

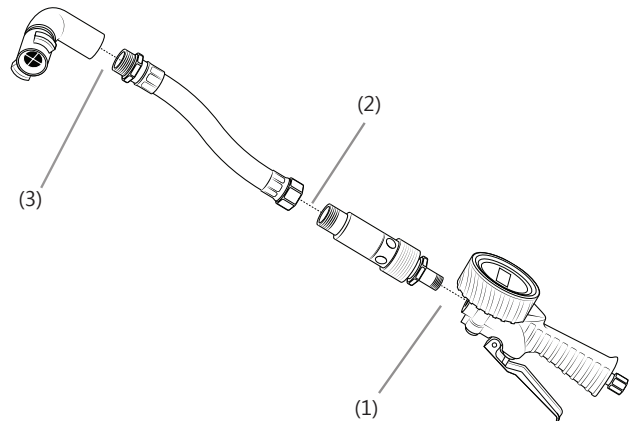

## PSI GAUGE

The Digital Inflator is precalibrated so there's no need to calibrate the gauge before use. If your gauge isn't working properly, you will need to purchase a replacement.

# OPERATION INSTRUCTIONS

1. Place a Shippers Products dunnage airbag in the void at least 1 inch above floor. No part of the airbag should protrude beyond the edge of the load.
2. Open the airbag valve cap and snap on the inflator tip.
3. Press the ON button on the digital gauge and make sure that the gauge is set on your measurement of choice. If it is not set on your desired measurement, press and hold the ON/UNIT button until the measurement unit changes. Repeat as necessary until the desired measurement unit is selected. If you need additional lighting to view the numbers, press the LIGHT button.
4. Ensure that the Venturi Sleeve is in the open position and squeeze the lever located on the DI Base to begin rapid low pressure inflation. The Venturi openings will draw in ambient air (**refer to Figure A**).
5. **When pressurized air begins to flow out of the Venturi openings, close the Venturi Sleeve to begin high pressure inflation cycle (refer to Figure B). In order to obtain accurate static air pressure reading, stop the inflation cycle and read the gauge.** Repeat as necessary until optimal air pressure is achieved.
6. Once the optimal air pressure is reached, remove inflator tip from the valve.
7. Verify pressure of the airbag no less than 15 minutes after initial inflation.
8. Secure the valve cap.

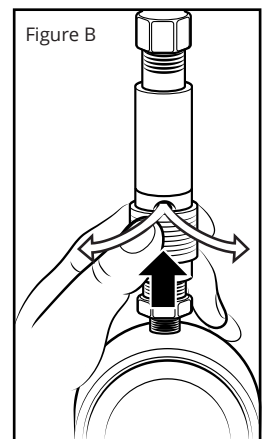
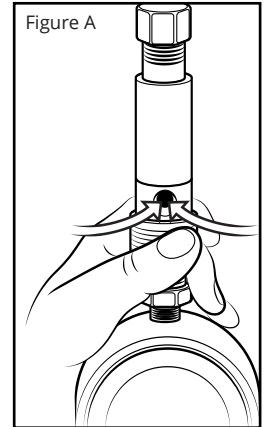

# SAFETY & WARNINGS

- Always wear safety glasses with side shields which conform to ANSI standard Z87.1 or EN166.
- Never use air source for cleaning.
- Never exceed maximum operating pressure stated on the airbag.
- Never point hose towards face or body.
- Only use unit with Shippers Products airbags.
- Do not submerge the unit in water.
- Use a filter and regulator on air line. Do not exceed 80 PSI incoming air line pressure.
- Store the unit in a dry area. Do not operate or expose unit to wet weather elements.
- Failure to follow these safety instruction could result in serious injury.
- LIABILITY OF THE UNIT IS LIMITED TO THE REPLACEMENT OF THE UNIT ONLY.